

2023 Contract & In-House CONSTRUCTION PROJECTS

LEGEND	
2022 Bridge Projects Carryover	
2022 Road Projects Carryover	
Roads By Contract (Rxxx)	
Bridge Replacement by Contract (Bxxx)	
Asphalt Rejuvenation (R175-A)	
Nova Chip (R175-B)	
BM-2 Overlay (R175-E)	
Crack Seal (R175-H)	
Hot In-Place Recycle (R175-M)	
BM-2 Overlay (By County Crews)	
Scrub Seal (By County Crews)	
Crack Seal (By County Crews)	
Bridges by County Crews (R264)	
Drainage Projects by Contract	

SCALE OF MILES
0 1 2 3 4 5

SEDGWICK COUNTY KANSAS

MAP LEGEND	
	Federal or State Highway (Multi-Lane)
	Federal or State Highway (2 Lane)
	County Highway (Paved) (Multi-Lane)
	County Highway (Paved) (2 Lane)
	County Maintained Sand Road
	Connecting Link
	Township/Other Road
	Unimproved
	Section Line (No Road)
	Township Line
	City Limits—Other towns
	City Limits—Wichita
	Railroad
	Lakes & Ponds
	Rivers and Drainage Courses

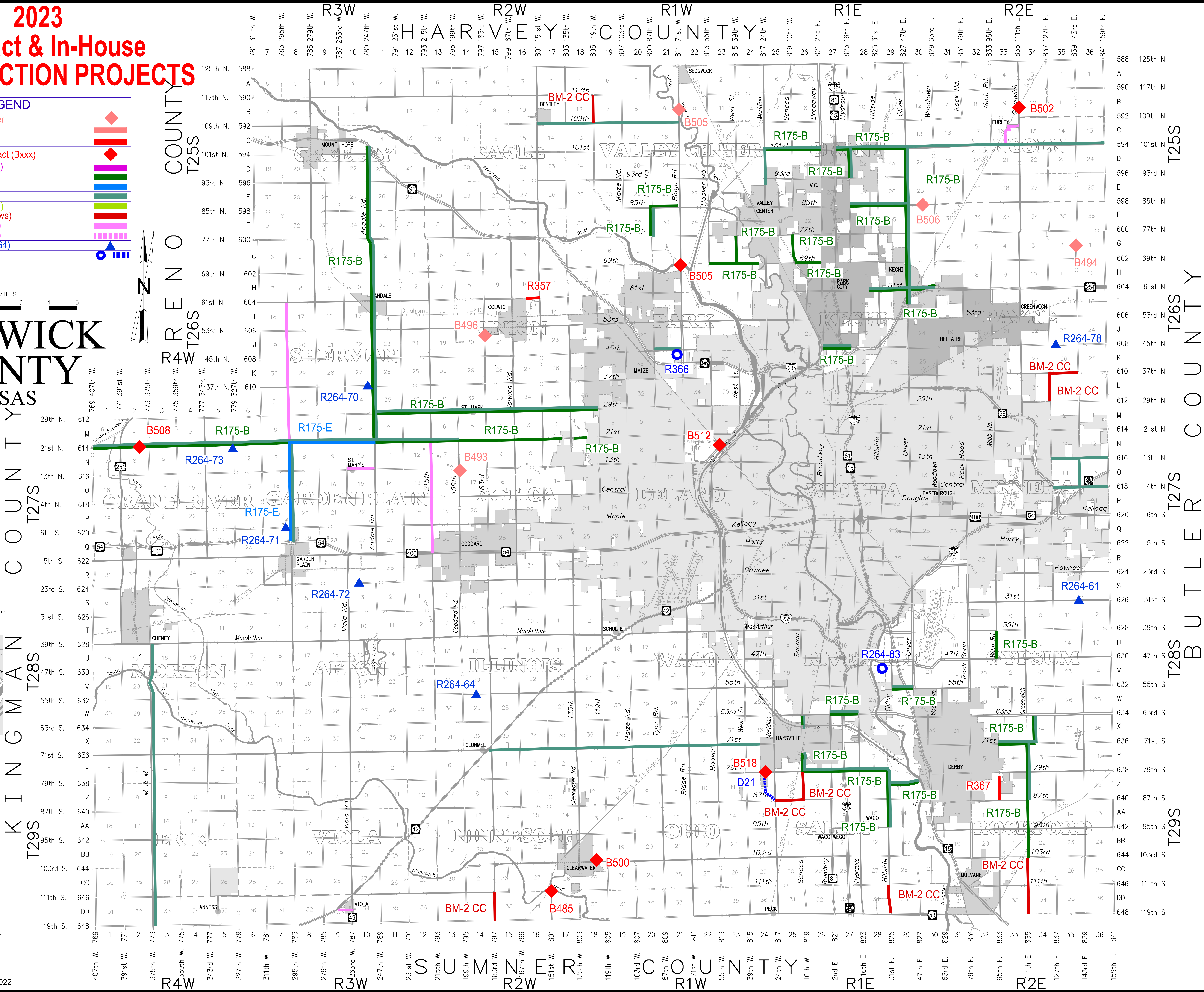
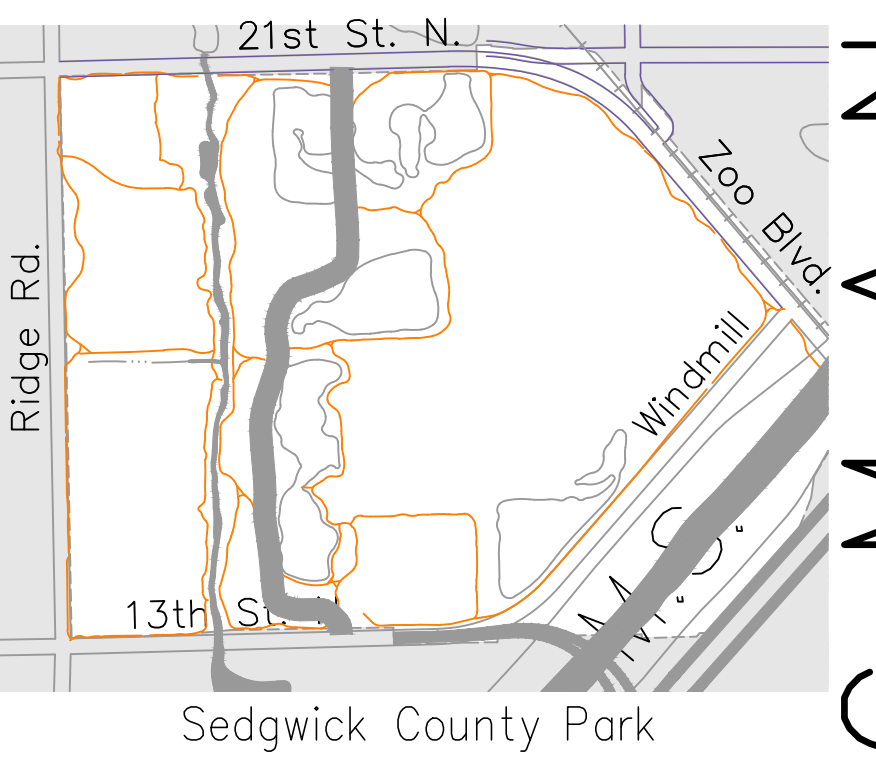

Sedgwick County Public Works
1144 S. Seneca
Wichita, Kansas 67213
(316) 660-1777
www.sedgwickcounty.org
City Limits updated as of 12-08-2022