

COUNTY	STATE	PROJECT NUMBER	FISCAL YEAR	SHEET NO.	TOTAL SHEETS
SEDGWICK	KANSAS	#####	####	####	##

[ROAD] BRIDGE 20

PETER F. MEITZNER
1st DISTRICT

SARAH LOPEZ
2nd DISTRICT

DAVID T. DENNIS
3rd DISTRICT

RYAN K. BATY
4th DISTRICT

JAMES M. HOWELL
5th DISTRICT

SEDGWICK COUNTY COMMISSIONERS

LYNN T. PACKER, P.E.

DIRECTOR - SEDGWICK COUNTY PUBLIC WORKS

CONTRACTOR _____

CONSULTING ENGINEERS _____

BRIDGE NO. ____ - ____ - ____

DESIGN LOADING HL-93

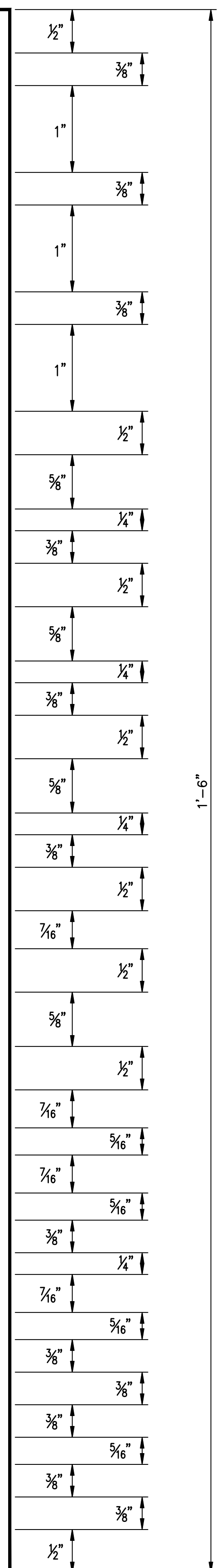

1'-6"

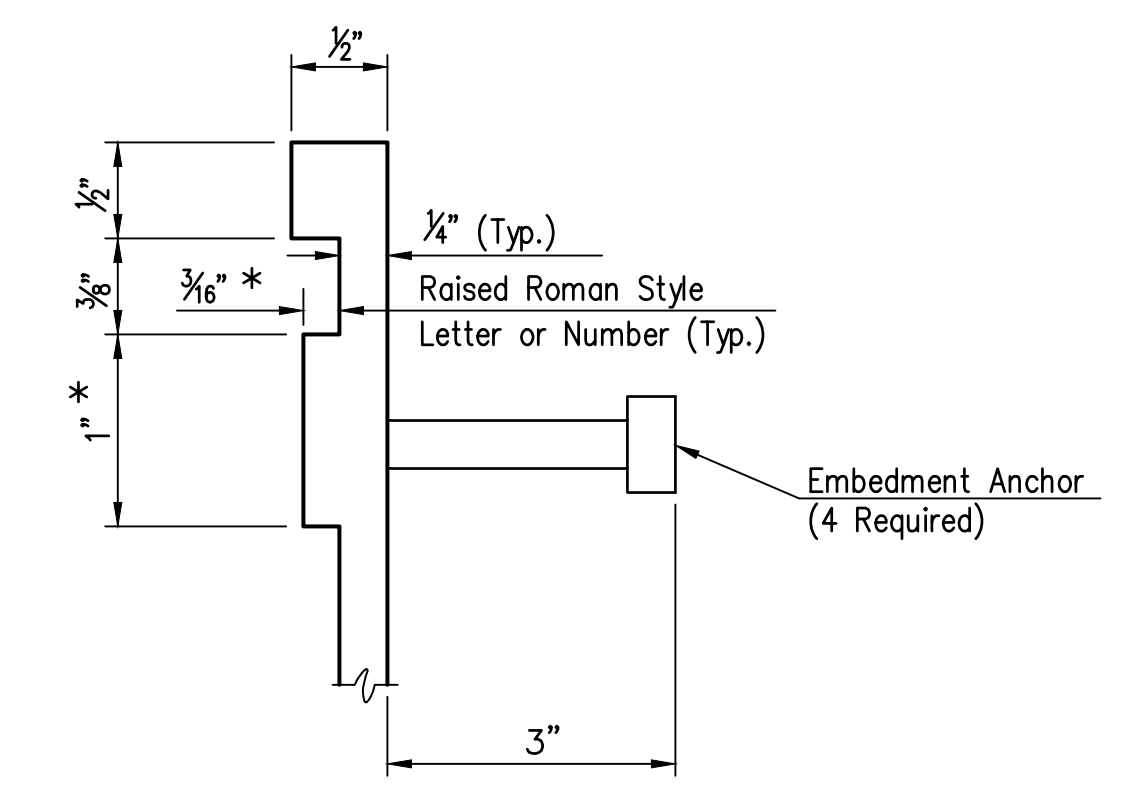

SECTION A-A

- NOTES:**
- * Variance of dimensions from Section 1625-Standard Specifications, 2015 Edition, Kansas Department of Transportation.
 - Marker to be furnished and installed by the Contractor, SUBSIDIARY to the bid item "Concrete (Grade 4.0)(AE)(**)" (2 Required).
 - See Sheet No. SheetNumber for location.
 - ** Aggregate as specified in Division 1100, if applicable.

Date	Description	By /Chk
11/2017	Chg. bridge marker note & design specification.	LTP /DJS
3/2015	Chg. Design Load to HL-93	JSB /LP
3/2008	Chg. Spec to 2007 Edition	DRS /DVR

#####

BRIDGE PROJECT MARKER

STRUCTURE NO. XXX-XX-XXXX (B-XXX) STA. 00+00.00

PREPARED BY
SEDGWICK COUNTY PUBLIC WORKS
HIGHWAY DEPARTMENT

LYNN T. PACKER, P.E. DIRECTOR/COUNTY ENGINEER

SCALE	DESIGNED	DRAWN	CHECKED	SHEET NO.
	D.V.R.		L.T.P.	###
DATE				

DWG: Bridge Project Marker-large.dwg

Device: AutoCAD PDF (General Documentation).pc3 Page Setup: ----- By: Salmans, John
\\diopw\cag\Blocks\STANDARDS\Bridges\Project Marker-large.dwg Layout: BPM-Large Plotted: 3/27/2023 1:47 PM

