

Device: DWG To PDF.pc3 Page Setup: NPS\_0 By: Packer, Lynn T. Q: \Blocks\Bridges\Bridges Project Marker-large.dwg Layout: BPM-Large Plotted: 11/6/2017 4:40 PM

COUNTY	STATE	PROJECT NUMBER	FISCAL YEAR	SHEET NO.	TOTAL SHEETS
SEDGWICK	KANSAS	#####	###	###	##

# ROAD BRIDGE 20

DAVID M. UNRUH    MICHAEL B. O'DONNELL II  
1st DISTRICT        2nd DISTRICT

DAVID T. DENNIS    RICHARD RANZAU  
3rd DISTRICT        4th DISTRICT

JAMES M. HOWELL  
5th DISTRICT

SEDGWICK COUNTY COMMISSIONERS

DAVID C. SPEARS, P.E.  
ASST. COUNTY MANAGER / COUNTY ENGINEER

CONTRACTOR \_\_\_\_\_

CONSULTING ENGINEERS \_\_\_\_\_

BRIDGE NO. \_\_\_\_ - \_\_\_\_ - \_\_\_\_

DESIGN LOADING HL-93

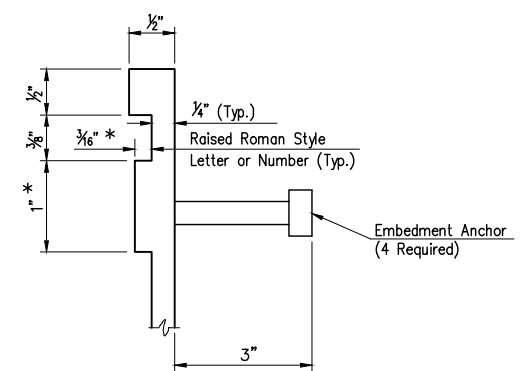
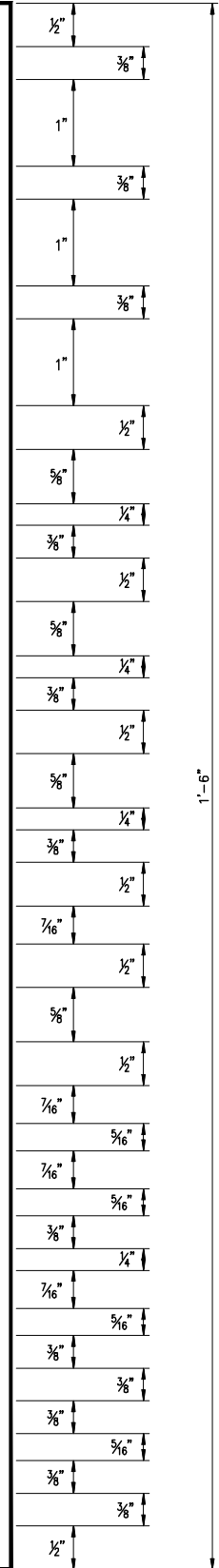

SECTION A-A

**NOTES:**

- \* Variance of dimensions from Section 1625-Standard Specifications, 2015 Edition, Kansas Department of Transportation.
- Marker to be furnished and installed by the Contractor, SUBSIDIARY to the bid item "Concrete (Grade 4.0)(AE)(\*\*)" (2 Required).
- See Sheet No. SheetNumber for location.
- \*\* Aggregate as specified in Division 1100, if applicable.

11/2017	Chg. Co. Eng. title, br. marker note, & design spec.	LTP/DJS
3/2015	Chg. Design Load to HL-93	JSB/LP
3/2008	Chg. Spec to 2007 Edition	DRS/DVR
Date	Description	By /Chk
#####		
<b>BRIDGE PROJECT MARKER</b>		
STRUCTURE NO. XXX-XX-XXXX (B-XXXX)      STA. 00+00.00		
PREPARED BY SEDGWICK COUNTY PUBLIC WORKS HIGHWAY DEPARTMENT		
DAVID C. SPEARS, P.E.		DIRECTOR/COUNTY ENGINEER
REVISED	SCALE	DESIGNED
		D.V.R.
		CHECKED
		P.L.E.
	DATE	
		#####

DWG: Bridge Project Marker-large.dwg