

Device: DWG To PDF.pc3 Page Setup: ----- By: Nixon, Nathan G. C:\Nixon\New CAD Standards\Bridge Project Marker-small.dwg Layout: Bridge Project Marker - Small Plotted: 12/10/2020 3:09 PM

COUNTY	STATE	PROJECT NUMBER	FISCAL YEAR	SHEET NO.	TOTAL SHEETS
SEDGWICK	KANSAS	#####	####	####	##

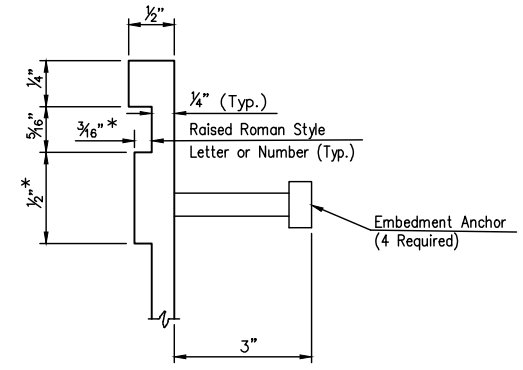
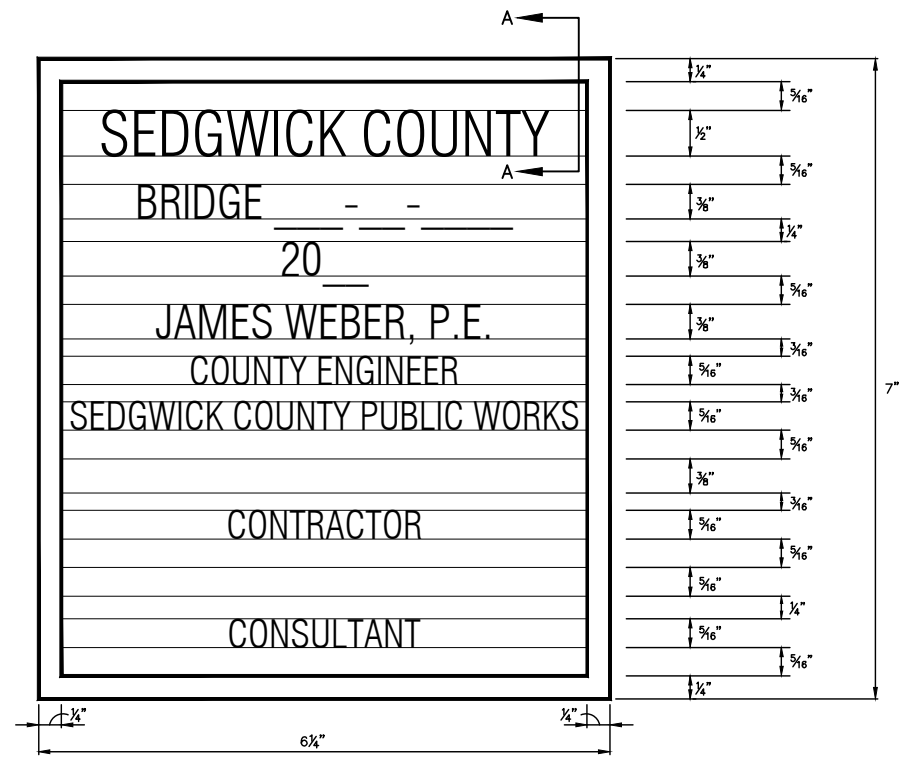

NOTES:
 * Variance of dimensions from Section 1625-Standard Specifications, 2015 Edition, Kansas Department of Transportation.
 Marker to be furnished and installed by the Contractor, SUBSIDIARY to the bid item "Concrete (Grade 4.0)(AE)" (2 Required).
 See Sheet No. SheetNumber for location.

11/2017	Chg. marker Eng. title, br. marker note, & design spec.	LTP /DJS
3/2008	Chg. Spec to 2007 Edition	DRS /DVR
Date	Description	By /Chk
#####		
CULVERT PROJECT MARKER		
STRUCTURE NO. XXX-XX-XXXX (BXXX) STA. XX-XX.XX		
PREPARED BY SEDGWICK COUNTY PUBLIC WORKS HIGHWAY DEPARTMENT		
JAMES WEBER, P.E.		DIRECTOR/COUNTY ENGINEER
SCALE	DESIGNED	DRAWN
	D.V.R.	
DATE	CHECKED	SHEET NO.
	L.T.P.	###
DWG: Bridge Project Marker-small.dwg		