

|          |        |                |             |           |              |
|----------|--------|----------------|-------------|-----------|--------------|
| COUNTY   | STATE  | PROJECT NUMBER | FISCAL YEAR | SHEET NO. | TOTAL SHEETS |
| SEDGWICK | KANSAS | #####          | ####        | ###       | ##           |

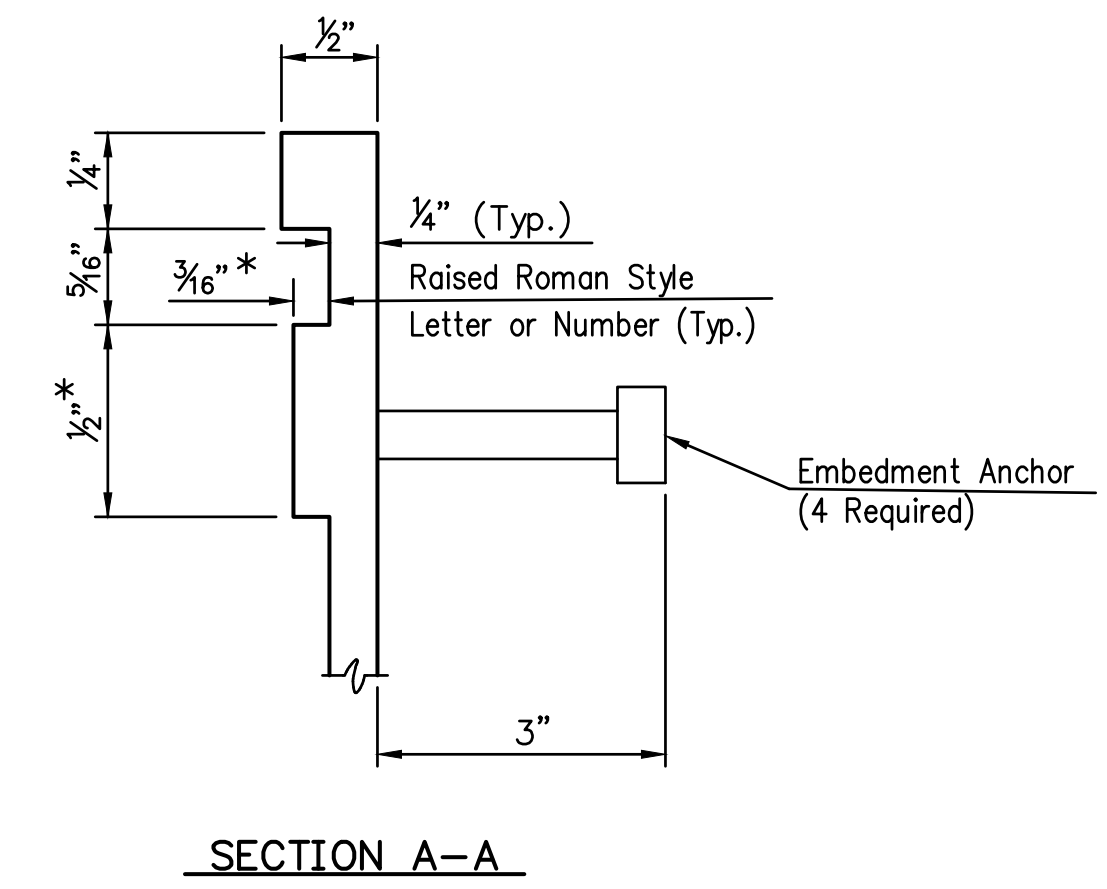
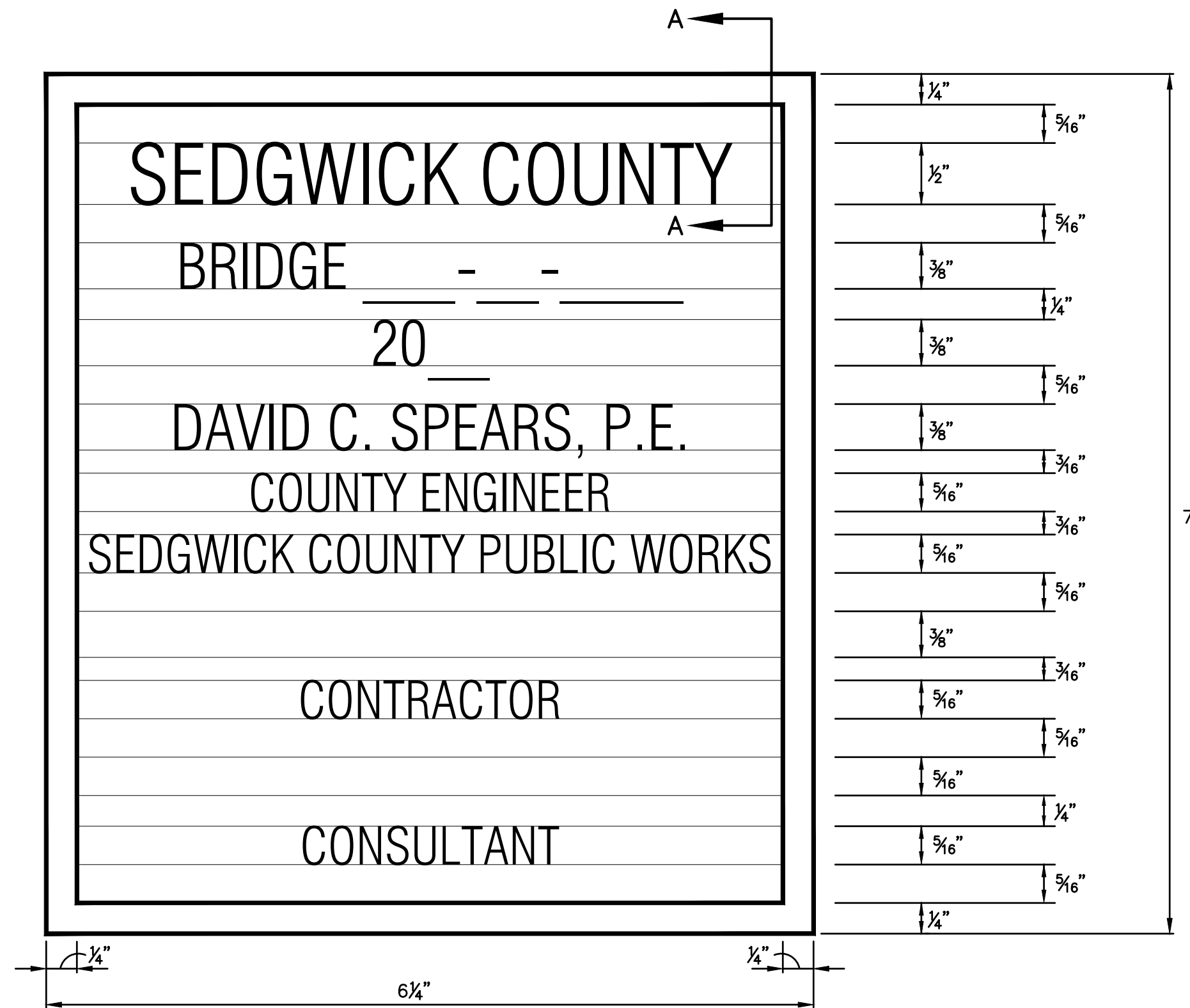

**NOTES:**  
 \* Variance of dimensions from Section 1625-Standard Specifications, 2015 Edition, Kansas Department of Transportation.  
 Marker to be furnished and installed by the Contractor, SUBSIDIARY to the bid item "Concrete (Grade 4.0)(AE)" (2 Required).  
 See Sheet No. SheetNumber for location.

Device: AutoCAD PDF (General Documentation).pc3 Page Setup: ----- By: Packer, Lynn T. Q:\Blocks\Bridges\Bridges\Project Marker-small.dwg Layout: Bridge Project Marker - Small Plotted: 7/3/2019 3:58 PM

|   |   |                          |
|---|---|--------------------------|
| 11/2017   | Chg. marker Eng. title, br. marker note, & design spec. | LTP /DJS                 |
| 3/2008  | Chg. Spec to 2007 Edition                               | DRS /DVR                 |
| Date  | Description   | By /Chk                  |
| #####   |   |                          |
| <b>CULVERT PROJECT MARKER</b>                                     |   |                          |
| STRUCTURE NO. XXX-XX-XXXX (BXXX) STA. XX-XX.XX                    |   |                          |
| PREPARED BY<br>SEDGWICK COUNTY PUBLIC WORKS<br>HIGHWAY DEPARTMENT |   |                          |
| DAVID C. SPEARS, P.E.   |   | DIRECTOR/COUNTY ENGINEER |
| SCALE   | DESIGNED  | DRAWN                    |
|   | D.V.R.  | L.T.P.                   |
| DATE  |   |                          |
| DWG: Bridge Project Marker-small.dwg                              |   | ###                      |