

**Addendum Number One**  
To The Drawings and Specifications for  
**SEDGWICK COUNTY – Waiting Room Addition**

Issued: **Tuesday, August 11, 2020**

**HANNEY & ASSOCIATES ARCHITECTS**  
1726 South Hillside, Wichita, Kansas

**NOTICE TO BIDDERS**

You are hereby instructed to include in your bids the following changes and/or corrections to the Drawings and Specifications for the **Waiting Room Addition to the Sedgwick County Corrections building located at 622 East Central.**

The additions and/or corrections shall be considered as a part of the Contract Documents as if incorporated therein. Where the following corrections and/or additions vary from the conditions of the Drawings and Specifications, such following changes or additions shall govern.

**GENERAL CLARIFICATIONS:**

1. SPECIFICATIONS.

There were some questions regarding when the specifications for this project will be issued. The specifications are posted on the Sedgwick County website.

The County has two web sites: 1) Purchasing Website 2) Construction Project Website.

The direct link to the Purchasing website:

<https://www.sedgwickcounty.org/finance/purchasing/requests-for-bid-and-proposal/>

Construction Documents for project 20-0034 can be found at this link:

<https://www.sedgwickcounty.org/construction-projects/rfb-20-0034/?root=3273>

This is a direct link to the front-end documents:

<https://www.sedgwickcounty.org/media/57524/rfb-20-0034-project-manual.pdf>

<https://www.sedgwickcounty.org/media/57538/20-0034-front-ends.pdf>

2. CONSTRUCTION QUESTIONS.

All questions during Construction shall be directed to Sandy Anguelov, Sedgwick County project manager and/or Martin Hanney architect. The on-site staff does not have the contractual authority to direct work.

3. PARKING.

Construction parking and staging shall be focused on the yellow area shown on the site plan below. Additional space can be discussed once the project is under construction.

The red indicates the “no parking” area.

The red arrow indicates the temporary access to the South Building.

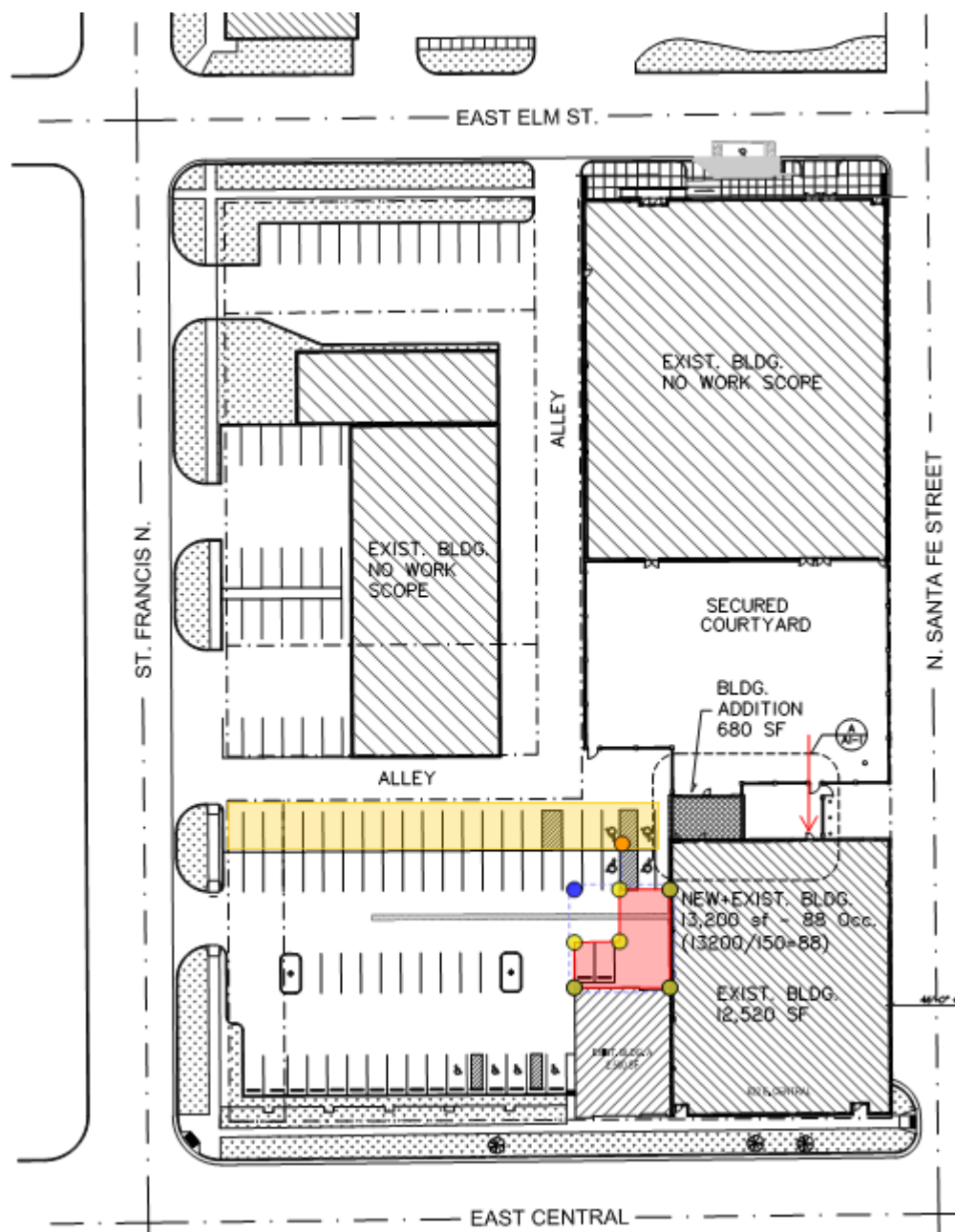

4. CONSTRUCTION FENCE.  
The General Contractor shall include in their Base Bid the cost for temporary construction fence to secure the site. This is especially important once the concrete fence is opened up for the new building addition. The temporary fence shall be chain-link and match the height of the existing concrete wall.
5. GAS METER.  
Considering the time this project will be beginning, the need to have the gas meter relocated and restored is very important. The gas meter may have to be located in the parking lot (on the West side of the concrete fence). If the gas meter is located in the parking, then the General Contractor shall include the cost to provide and install (2) 6" diameter, concrete filled, steel bollards set in concrete to a depth of 36" below the concrete paving.
  - a. There is a line and control valve to the left of the existing gas meter. This line and valve shall be relocated with this project.
6. STORAGE SHEDS.  
The Owner will be responsible for removing the contents of the sheds.  
The General Contractor will be responsible for temporarily moving the sheds out of the path of construction and then replacing them at the appropriate time. The final location the sheds shall be anchored to the slab to match the existing condition.
7. TEMPORARY ACCESS.  
The inmates that are housed in the building to the North access the Administration Building to the South. The Admin Building is the one where we are adding the new Waiting Room. A temporary path needs to be provided outside the construction area (staying within the courtyard). This path will be to the East of the construction area. When the GC is relocating the sheds, access to the South building shall be considered.
8. METAL DETECTOR, power.  
There is an outlet on the half-high wall adjacent to the metal detector that is shown on the plans. The outlet shown on this half-high wall is for the metal detector.
9. SHEET A3.2
  - a. Room Finish Schedule, Waiting Room, floor finish is shown as "S/C"; this indicates "sealed concrete".
  - b. Room Finish Notes, Floor: there is "N.S. add.", this indicates "non-slip additive".
10. SMOKING on Campus.  
Smoking in the courtyard is allowed.  
Smoking in the building is not allowed.
11. CIGARETTE LIGHTER.  
There is an existing cigarette lighting device mounted to the North side of the concrete fence. The General Contractor shall remove the power to the unit. The Owner will remove and relocate the unit.