



SEDGWICK COUNTY, KANSAS  
DIVISION OF FINANCE  
*Purchasing Department*  
525 N. Main, Suite 823 ~ Wichita, KS 67203  
Phone: 316 660-7255 Fax: 316 383-7055  
<http://sedgwickcounty.org/finance/purchasing.asp>

**ADDENDUM 2  
RFB #21-0038  
1ST FLOOR TRAFFIC COURT REMODEL**

May 28, 2021

The following is to ensure that vendors have complete information prior to submitting a bid. Here are some clarifications regarding the bid for 1st Floor Traffic Court Remodel.

**The Last Question Submittals time has been extended to 5:00 pm, Tuesday, June 1<sup>st</sup>, 2021.**

**The Last Addenda Issuance time has been extended to Thursday, June 3<sup>rd</sup>, 2021.**

**See additional information attached**

Firms interested in submitting a *bid*, must respond with complete information and **deliver on or before 1:45 pm CDT, June 8, 2021**. Late *bids* will not be accepted and will not receive consideration for final award.

**“PLEASE ACKNOWLEDGE RECEIPT OF THIS ADDENDUM ON THE *BID* RESPONSE PAGE.”**

---

Britt Rosencutter  
Purchasing Agent

BR/ch

This Addendum is hereby made part of the Contract Documents to the same extent as though it were originally included therein.

5 All Contractors, Subcontractors and suppliers are reminded that they shall be familiar with all Addenda items (as well as all parts of the Construction Documents) so as to understand the extent of their work and its interrelation with other trades.

To all bidders for furnishing all labor and materials necessary for the following Contract:

10 **SEDGWICK CO COURTHOUSE – 1<sup>st</sup> FLOOR TRAFFIC COURT REMODEL**  
**Sedgwick County**

15 525 N. Main  
 Wichita, KS 67203

20 Prepared by:  
 Schaefer Johnson Cox Frey Architecture, Inc.

**05/20/21 PRE-BID MEETING:**

Attendee's:

- 25 Aaron Hoy, Harman Huffman, 316-744-2081, [ahoy@harmanhuffman.com](mailto:ahoy@harmanhuffman.com)  
 Jeff VanAsdale, VanAsdale Construction, 316-264-0222, [vanasdaleconstruction@gmail.com](mailto:vanasdaleconstruction@gmail.com)  
 Doug Henning, Commerce Construction, 316-262-6654, [dougcccswichita.com](mailto:dougcccswichita.com)  
 Gib Compton, Compton Construction, 316-262-8885, [estimating@comptonconst.com](mailto:estimating@comptonconst.com)  
 30 Gabe Probst, Dondlinger, 316-945-0555, [gprobst@dondlingerconst.com](mailto:gprobst@dondlingerconst.com)  
 Justin Graham, SJCF Architecture  
 Ashley Markley, SJCF Architecture  
 Valerie Kaster, SC  
 Darrel Hayne, SC  
 35 Clark Weimeyer, SC

Questions:

- 40 1. Q: Can contractors come to site for a second follow-up review and walk-thru?  
 A: A second walk-thru time has been scheduled for Tuesday, May 25<sup>th</sup> from 9:00am – 10:00am.
2. Q: Does phase 1 need to be complete before starting phase 2?  
 A: Yes. The phasing is due to the need to shuffle employees from space to space.
- 45 3. Q: Regarding construction work volume; does this mean loud work needs to occur in the evenings and weekends.  
 A: The area of work should be relatively well buffered by adjacent walls, ceilings, and hallways. On occasion there is a larger group of people at the Treasury counters at lunch time but work can most likely commence through this.
- 50 4. Q: Will furniture be removed before work occurs?  
 A: Yes, the owner will remove the movable furniture items.
5. Q: Who's responsibility is it to remove the rolling shelf unit?

A: Owner will remove the rolling shelving unit.

6. Q: Where will dumpster be stored?

A: The dumpster can be stored on the east wall in the gated Facility Parking lot on the north side of the building.

7. Q: Where is the sprinkler system located?

A: The sprinkler system starts at the east entry to the Detention portion of the facility.

8. Q: Will work in the Sheriff’s area (holding cells and west bathroom) need to be secured?

A: Yes. Detainees are walked through this hallway frequently and so tools and the work areas will need to be secured during and after work.

9. Q: Do contractors working in the Sheriff’s area (holding cells and west bathroom) need to have background checks?

A: Yes, contractors working in this area will need background checks and PREA training will be mandatory.

10. Q: Will contractors be able to work evenings and weekends in the Sheriff’s area (holding cells and west bathroom)?

A: Evening and weekend work in the main courthouse and in the tunnel is ok but will need to be scheduled with the County’s project manager.

**05/25/21 WALK-THRU:**

Attendee list attached.

Questions:

1. Q: Check that the 3 cypher locks would not be preferred to be access card readers.

A: There is only one cypher lock, scheduled at door 104A.

2. Q: Will the project be reusing all of the existing panels?

A: Yes.

3. Q: Is saw cutting of the floor boxes by electrical contractor or others?

A: To be determined and coordinated by bidders.

4. Q: Will outlets in the vicinity of the holding cells be surface mounted?

A: No.

5. Q: Is there a ceiling or secure ceiling being installed in the holding cells?

A: Yes, 2x2 detention grade ceiling is called out for both holding cells rooms 122 and 123, as well as the inmate toilet room 121.

6. Q: Which side of door 101A is the door access reader called out for?

A: The access reader is called out to be prepped for future install on both sides of the door.

**GENERAL:**

5 **ITEM AD2-A01** SPECIFICATIONS, 09 65 00 RESILIENT FLOORING:  
 REVISION 2.01B, #4. Remove "0.020 inch (0.50 mm)" and replace with "0.028 inch (0.71 mm)"

10 **ITEM AD2-A02** SPECIFICATIONS:  
 REVISION The following manufacturers have been approved in the sections indicated, provided their product satisfies all requirements of the specifications and contract documents:

SECTION	PRODUCT	MANUFACTURER
08 11 13	HM Doors & Frames	Mesker
11 19 00	Det HM Doors, Frames, Furn	Sweeper Mtl. Fabricators Corp.

20 **ITEM AD2-A03** SPECIFICATIONS, 12 50 00 FURNITURE:  
 ADDITION Add spec section 12 50 00 – Furniture, for courtroom seating as attached.

25 **ITEM AD2-A04** DRAWINGS, A29.1 FFE PLAN:  
 ADDITION Add drawing sheet A29.1 – FFE Plan as attached.

30 **MECHANICAL:**  
 None

35 **ELECTRICAL:**  
 None

**END OF ADDENDUM NUMBER TWO**

**PRE-BID/PROPOSAL MEETING  
RFB #21-0038**

**PROJECT:** 1st Floor Traffic Court Remodel  
**LOCATION:** 525 N. Main, Ste. 107, Wichita, Kansas 67202  
**DATE:** 5/25/2021 **TIME:** 9:30 AM

\*\*\*PLEASE PRINT CLEARLY SHOULD WE NEED TO CONTACT YOU AT A LATER DATE\*\*\*

<i>CONTACT PERSON</i>	<i>COMPANY NAME</i>	<i>E-MAIL ADDRESS</i>	<i>PHONE NUMBER</i>	<i>FAX NUMBER</i>
Lee Barrier	Sedgwick County	Lee.Barrier@sedgwick.gov	316-660-7258	
Valerie Kaster	Sedgwick County	Valerie.Kaster@sedgwick.gov	316-660-9080	
Lacey Jeffrey	Sedgwick County	Lacey.Jeffrey@sedgwick.gov	316-660-7240	
Marc Brown	Phillips Southern etc	marc@phillips-southern.org	620-897-2533	
Jeremy Long	Sandifer Engineering	Jeremy@sandifercontrols.com	316-617-0046	

Purchasing Tech (name) Lacey Jeffrey  
 Date posted to website \_\_\_\_\_

Addenda sent to all attendees (email) at Pre-bid meeting and the original bidder list \_\_\_ Yes \_\_\_ No

Email address(es) added to the SAP Bidder List \_\_\_ Yes \_\_\_ No

**SECTION 12 50 00 - FURNITURE****PART 1 GENERAL****1.01 SECTION INCLUDES**

- A. Tandem Guest Seating.

**1.02 REFERENCE STANDARDS**

- A. ASTM E 84 - Standard Test Method for Surface Burning Characteristics of Building Materials; 2013a.

**1.03 SUBMITTALS**

- A. See Section 01 30 00 - Administrative Requirements, for submittal procedures.
- B. Product Data: Provide specification sheets on products including model number, accessories and finishes.
- C. Shop Drawings: Indicate dimensions and layout.
- D. Manufacturer's Instructions: Indicate clean and care instructions.
- E. Warranty: Submit manufacturer warranty and ensure that forms have been completed in Owner's name and registered with manufacturer.

**1.04 QUALITY ASSURANCE**

- A. Installer Qualifications: Company specializing in performing the work of this section with minimum three years of experience.

**1.05 DELIVERY, STORAGE, AND HANDLING**

- A. Store in accordance with manufacturer's requirements. Do not store furniture in manner that will crush the packaging.
- B. Protect furniture with original manufacturer's packaging.
- C. Maintain uniform temperature of minimum of 60 degrees F (16 degrees C) and maximum humidity of 60 percent prior to, during and after installation.

**1.06 WARRANTY**

- A. Correct defective Work within a one year period after Date of Substantial Completion.
- B. Provide one year manufacturer warranty for furniture.
- C. Guarantees which are standard guarantees provided by a manufacturer for his product shall be received by the Contractor, filled out and filed with the company for the Owner. Certificates or registration stubs shall be included with the shop drawings submitted for the Owner upon completion of the work. The Contractor's responsibility stipulated in the

paragraph before this one, terminates as stipulated therein. The Owner shall administrate manufacturer's warranties/guarantees thereafter.

## **PART 2 PRODUCTS**

### **2.01 ITEM # 1**

- A. Manufacturer: KFI Seating provided by School Outfitters.
- B. Model Number: KFI-2000B-4.
- C. Description: 2000 Series Beam Seating.
- D. Specifications:
  - 1. Dimension: 95" width x 22" depth x 31" high.
  - 2. Quantity: 11 total, Refer to FFE Plan.
  - 3. Polypropylene Seat/Back.
  - 4. Finish:
    - a. Seat Color: Charcoal.
    - b. Frame Finish: Black
  - 5. Warranty: 12 year limited
  - 6. Bidder to install listed product.

### **2.02 ITEM # 2**

- A. Manufacturer: KFI Seating provided by School Outfitters.
- B. Model Number: KFI-2000B-3.
- C. Description: 2000 Series Beam Seating.
- D. Specifications:
  - 1. Dimension: 71" width x 22" depth x 31" high.
  - 2. Quantity: 10 total, Refer to FFE Plan.
  - 3. Polypropylene Seat/Back.
  - 4. Finish:
    - a. Seat Color: Charcoal.
    - b. Frame Finish: Black

5. Warranty: 12 year limited
6. Bidder to install listed product.

**2.03 ITEM # 3**

- A. Manufacturer: KFI Seating provided by School Outfitters.
- B. Model Number: KFI-2000B-2.
- C. Description: 2000 Series Beam Seating.
- D. Specifications:
  1. Dimension: 47" width x 22" depth x 31" high.
  2. Quantity: 4 total, Refer to FFE Plan.
  3. Polypropylene Seat/Back.
  4. Finish:
    - a. Seat Color: Charcoal.
    - b. Frame Finish: Black
  5. Warranty: 12 year limited
  6. Bidder to install listed product.

**PART 3 EXECUTION**

**3.01 See Section 01 70 00 for additional requirements.**

**3.02 INSTALLATION**

- A. Install in accordance with manufacturer's instructions.

**3.03 ADJUSTING**

- A. Adjust moveable components for smooth operation.

**3.04 CLEANING**

- A. Remove all packaging materials, waste and trash from the site. Dispose of according to regulations.
- B. Installer to pay for waste and trash disposal.
- C. Furniture to be cleaned and wiped down of dust and foreign materials.



**3.05 CLOSEOUT ACTIVITIES**

- A. See Section 01 78 00 - Closeout Submittals, for closeout submittals.
- B. Demonstrate proper operation of furniture to Owner's designated representative.

**3.06 PROTECTION**

- A. Protect installed furniture from subsequent construction operations.

**END OF SECTION**

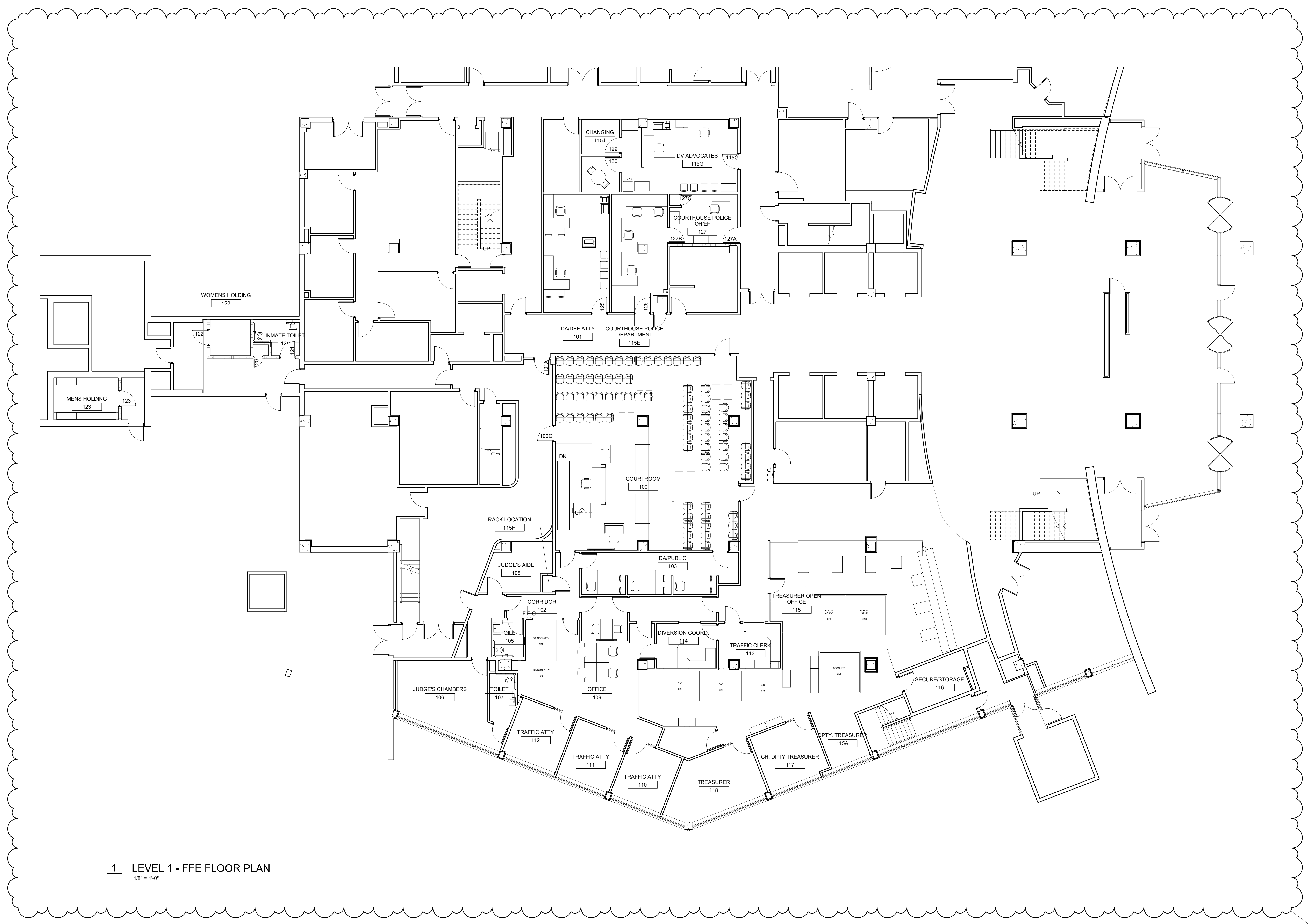

**1 LEVEL 1 - FFE FLOOR PLAN**  
1/8" = 1'-0"

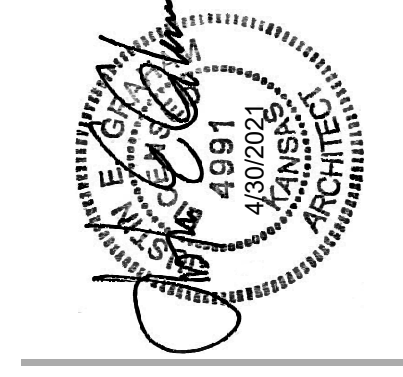

©2020  
Schafer Johnson Cox Fry Architecture, Inc.  
All Rights Reserved.  
These drawings and their contents, including, but not limited to, all concepts, designs, or ideas are the exclusive property of Schafer Johnson Cox Fry Architecture, Inc. and may not be used or reproduced in any way without the express consent of SJCF.

**REVISIONS**

1	ADD#1 28 MAY 2021
---	-------------------

PROJECT NUMBER	5278.31
DATE	15 APRIL 2021
FFE FLOOR PLAN	