

Device: PDF-XChange For AcroPlot Pro (temporary).pc3 Page Setup: ----- By: Rhein, Jessica J. Q:\Blocks\STANDARDS\Bridge Project Marker-large.dwg Layout: BPM-Large Plotted: 4/29/2025 11:30 AM

COUNTY	STATE	PROJECT NUMBER	FISCAL YEAR	SHEET NO.	TOTAL SHEETS
SEDGWICK	KANSAS	#####	####	####	##

[ROAD]
BRIDGE
20

PETER F. MEITZNER
1st DISTRICT

STEPHANIE WISE
3rd DISTRICT

JAMES M. HOWELL
5th DISTRICT

SEDGWICK COUNTY COMMISSIONERS

LYNN T. PACKER, P.E.

DIRECTOR - SEDGWICK COUNTY PUBLIC WORKS

JEFF BLUBAUGH
2nd DISTRICT

RYAN BATY
4th DISTRICT

CONTRACTOR

CONSULTING ENGINEERS

BRIDGE NO. - -

DESIGN LOADING HL-93

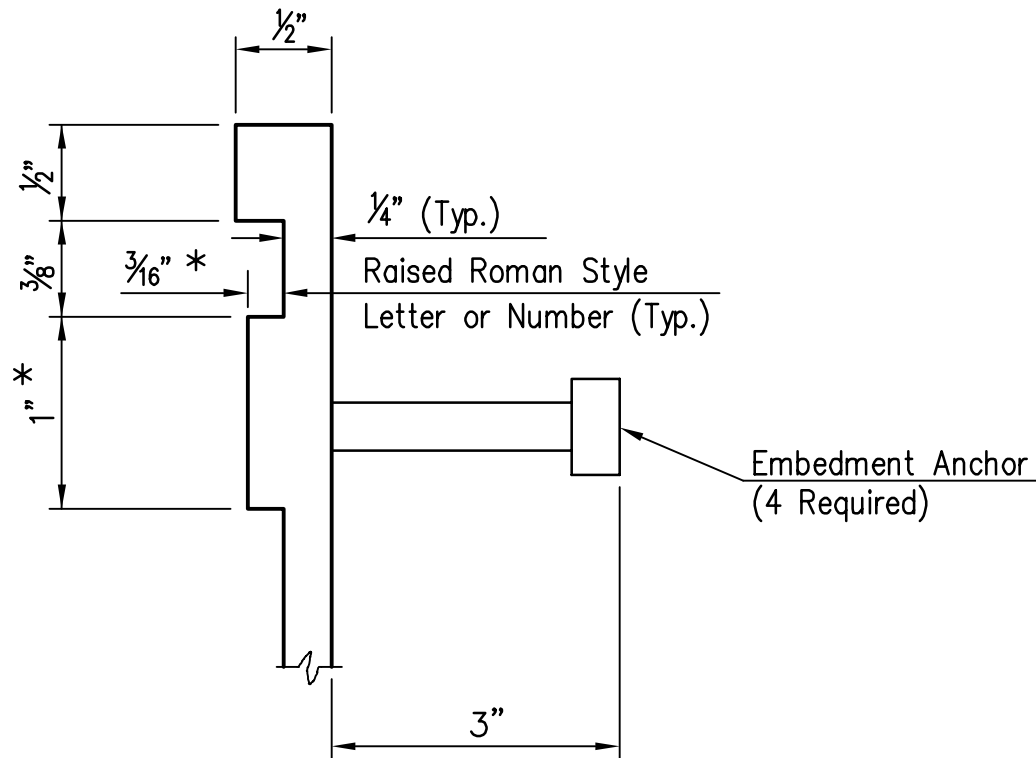
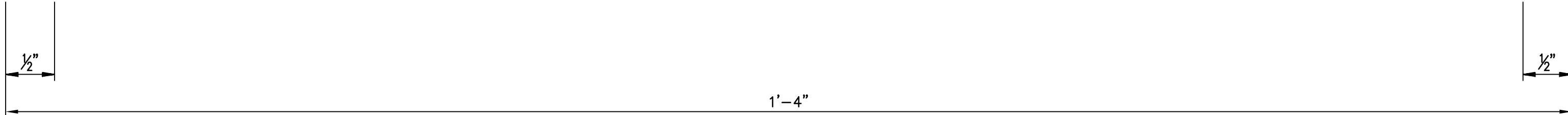
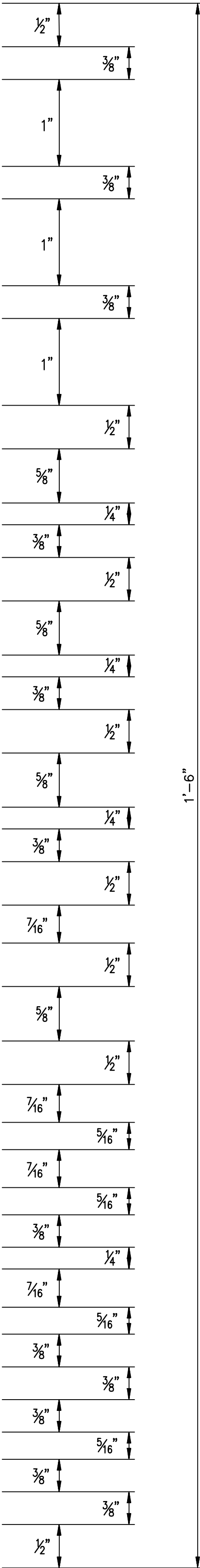

SECTION A--A

- NOTES:**
- * Variance of dimensions from Section 1625--Standard Specifications, 2015 Edition, Kansas Department of Transportation.
 - Marker to be furnished and installed by the Contractor, SUBSIDUARY to the bid item "Concrete (Grade 4.0)(AE)(**)" (2 Required).
 - See Sheet No. SheetNumber for location.
 - ** Aggregate as specified in Division 1100, if applicable.

11/2017	Chg. bridge marker note & design specification.	LTP /DJS
3/2015	Chg. Design Load to HL-93	JSB /LP
3/2008	Chg. Spec to 2007 Edition	DRS /DVR
Date	Description	By /Chk
#####		
BRIDGE PROJECT MARKER		
STRUCTURE NO. XXX-XX-XXXX (B-XXX) STA. 00+00.00		
PREPARED BY SEDGWICK COUNTY PUBLIC WORKS HIGHWAY DEPARTMENT		
LYNN T. PACKER, P.E.		DIRECTOR/COUNTY ENGINEER
SCALE	DESIGNED	DRAWN
	D.V.R.	
DATE	CHECKED	SHEET NO.
	L.T.P.	####
DWG: Bridge Project Marker-large.dwg		